

F06

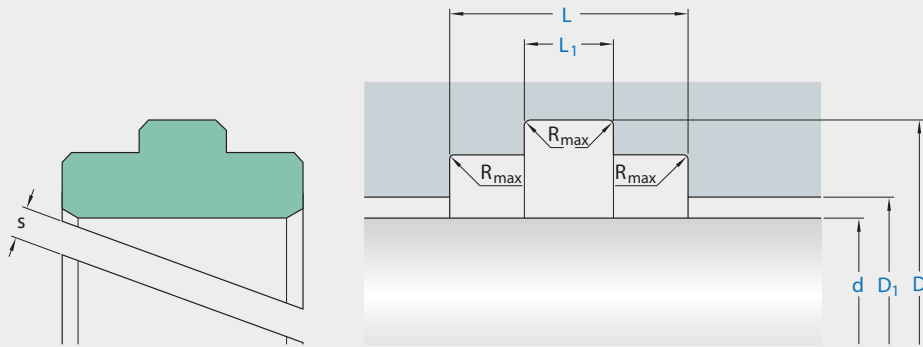

Ordering dimensions in blue

Sealing material Surface roughness	TPU / Elastomers		PTFE	
	R_{tmax}	R_a	R_{tmax}	R_a
	m		m	
Sliding surface	$\leq 2,5$	0,05–0,3	≤ 2	0,05–0,2
Bottom of groove	$\leq 6,3$	$\leq 1,6$	$\leq 6,3$	$\leq 1,6$
Groove face	≤ 15	≤ 3	≤ 15	≤ 3

Bearing area: 50–95% and a cutting depth of $0,5 R_z$ based on $C_{ref} = 0\%$

application



not bolded symbols; please consult our technical for application limitations

Standard dimensions		D	D ₁	D ₂	L	L ₁
d	f8	H10	H8		+0,2	+0,2
over	incl.					
mm						
5	36	d+6	d+2,8	d+0,35	8,5	3
36	60	d+7,5	d+3,2	d+0,4	10,5	3,5
60	90	d+9	d+3,5	d+0,5	15	5
90	150	d+9	d+3,5	d+0,6	15	5
150	200	d+16	d+7,1	d+0,7	20,3	8
200		d+17	d+7,5	d+0,8	25	8

* Cutting gap s † values depend on material and temperature. For detailed information please refer to the profile description.

operating parameters & material

diameter range: up to 600 mm

material	temperature	max. surface speed	max. specific load
Ecotal ²	-50 °C ... +100 °C	4,0 m/s	25 N/mm ²
Ecomid ²	-40 °C ... +100 °C	4,0 m/s	25 N/mm ²
Ecoflon 2	-200 °C ... +200 °C	4,0 m/s	3 N/mm ²
Ecoflon 3	-200 °C ... +200 °C	5,0 m/s	4,5 N/mm ²
TEX	-40 °C ... +130 °C	1,0 m/s	90 N/mm ²

the stated operation conditions represent general indications. it is recommended not to use all maximum values simultaneously. surface speed limits apply only to the presence of adequate lubrication film.

² Ecotal up to ø260 mm, Ecomid above ø260 mm.

seal & housing recommendations

please note that we are able to produce those profiles to your specific need or any non standard housing. for detail measurements, please see seal-mart catalog...

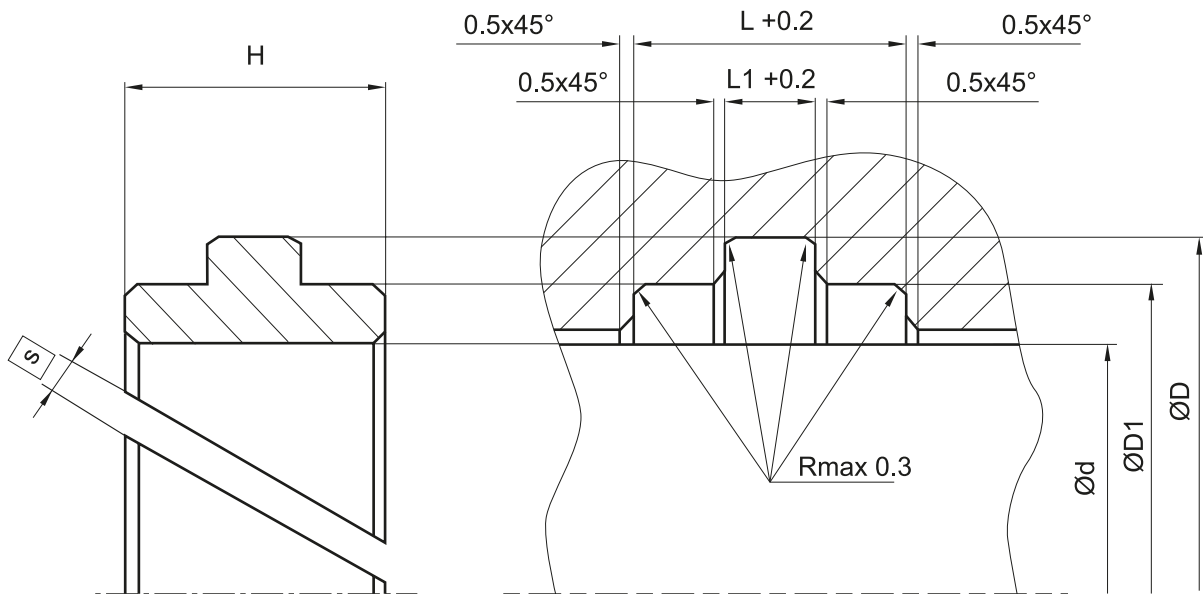

variations:

- cutting gap width $s = \dots$ mm
- endless

don't hesitate to contact our technical department for further information or for special requirements (temperature, speed etc.), so that suitable materials and/or designs can be recommended.